

P.C.B LAYOUT

Specifications:**1. Characteristics:**

Rated Voltage: 250V AC (Max)

Rated Current: 3A (Max)

Contact Resistance: 30 m MAX

Insulation Resistance: 3000 M MIN at 500V DC

Dielectric Withstanding Voltage: 250V AC RMS for 1 minute

Operating Temperature Range: -45°C to +85°C

2. Materials:

Housing: PBT UL94-V0 (Black)

Contacts: Brass, Gold/Flash Plated

SPCC (Nickel Plated)

SPCC (Tin Plated)

Rivet: Copper alloy, nickel-plated

Screws: Iron Alloy, Nickel Plated

3. Precautions:

a. No oxidation or rust should occur after a 12-hour salt spray test.

b. Finished products must be free from bent or defective pins.

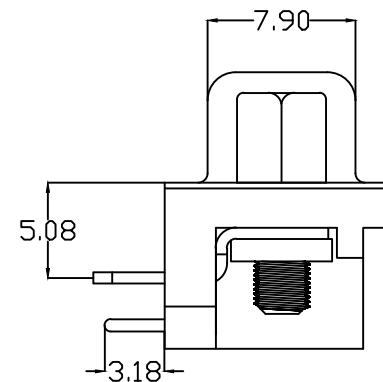

UNLESS OTHERWISE SPECIFIED TOLERANCE		Shenzhen Kinghelm Electronics Co., Ltd.		www.kinghelm.net	
ANG.	±5°	SCALE: AS SHOWN		UNIT: mm	
0.	±0.5				
.0	±0.3				
.00	±0.2				
DRAWN WAN		06/17/13		DRAWN NAME:	
CHECKED CHEN		06/17/13		DR9 Female 5.08 Rivet Lock	
APPROVED CHEN		06/17/13		PRODUCT NO.	
DATE		SIZE A4		REV. A	
				FILE NAME:	

A ECN-20130617001(WAN)

REV. DESCRIPTION

1 2 3 4 5 6 7 8 9 10