

Model: KH-DVI-24+5-AF90

NOTE:

1.Materials and Plating

Housing: PBT UL94V-0, White

Back Cover: PA66 UL94V-0, White

Digital Terminals: Brass, Nickel Base with Partial Gold over Tin Plating

Analog Terminals: Phosphor Bronze, Nickel Base with Partial Gold over Tin Plating

Metal Shell: SPCC, Thickness = 0.50mm Shell Plating: Nickel Plated

Fork Terminal: SPCC, Tin Plated

Rivets: Brass, Nickel Plated

Screws: Iron Alloy, Nickel Plated

2.Electrical Characteristics

Insulation Resistance: 1000 M Min

Withstanding Voltage: 500VAC / 1 minute

Contact Resistance: 30 m Max

Rated Current: 1.5 Amperes Min

3.Environmental Performance

Operating Temperature Range: -20°C to +85°C

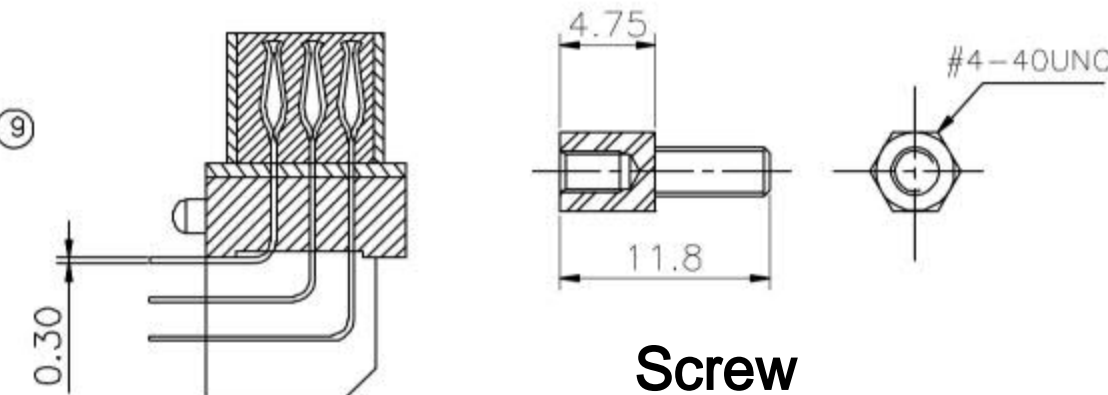
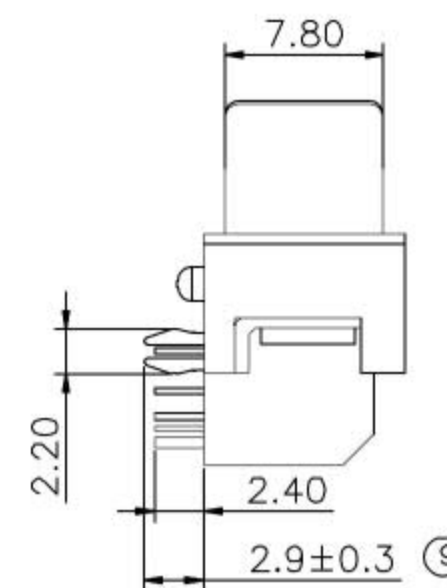

Screw

Shenzhen Kinghelm Electronics Co., Ltd.

一般公差 COMMONLY TOLERANCES	图名 DRW. NAME	成品图	绘图 PLOT	比例 SCALE	1:1
X.XXX ±0.15	料号 PART NO.	DVI 24+5	设计 DESIGN	单位 UNIT	MM
X.XX ±0.20	品名 TITLE	Female	审核 CHECKED	版次 REV.	00
X.X ±0.25		Connector,	核准 APPROVED	页次 SHEET	01
X ±0.30		90-Degree,			
ANGLE ±2°		Riveted Type			

图面发行

变更内容

签名

TEL:

TEL:

标记

REV. LTL

日期

DATE

A4

