

**Kinghelm®**

REVISIONS					
REV	NUMBER	DESCRIPTION	DWN	CHK	DATE
A		DESIGN			

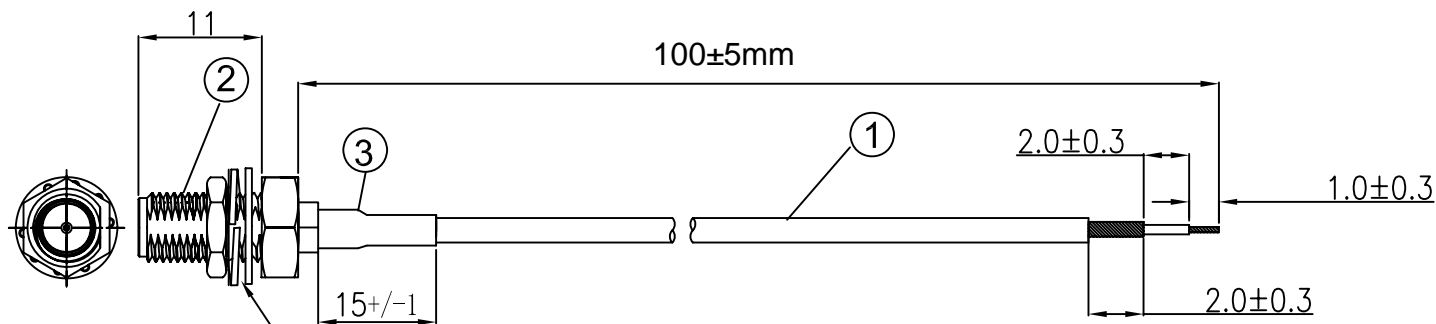

Three types of accessories  
(washers, nuts) are included  
with the shipment.

## NOTES:

### 1.ELECTRICAL:

1.1.VOLTAGE RATING:DCV 300V 10MS

1.2.CONDUCTANCE RESISTANCE:3.0 OHM/MAX.

13.INSULATION RESISTANCE:5.0M OHM/MIN.

1.4.THE CABLE SHOULD BE 100% ELECTRICAL TEST

1.5.IT SHOULD BE NO ANY OPEN/SHORT,MISWIRING  
AND INTERMITTENT FAILURES.

### 2.MATERIAL:

2.1.SEE TABLE

3.ALL COMPONENTS ARE RoHS COMPLIANT.

ITEM NO.	PART NUMBER	DESCRIPTION	QTY.
③	Ferrule	Black Heat Shrink Tubing, OD: 2.0mm	AS
②	Connector	SMA Female Jack with Female Contact Pin, Two-Piece, 11-Thread, Gold-Plated	1
①	Coaxial Cable	RF 178 Brown Cable, OD: 1.8mm	AS

Shenzhen Kinghelm Electronics Co., Ltd

www.kinghelm.net

**KH-122-178SMA-100**

ALL DIMENSION  
ARE IN MM

DRAWN Jamy

DATE 2020-06-15

ENG.

COMPUTER GENERATED  
IN SOLIDWORKS

MFG.

DO NOT SCALE  
THIS DRAWING

Q.A.

PROJECTION

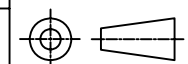

GENERAL TOLERANCE FOR

ANGLES X.X X.XX X.XXX  
± 1° ± 0.3 ± 0.25 ± 0.150

SMA /F TO OPEN L=100mm

SIZE Number

**B**

REV

**A**

SCALE: Free

TYPE

SHEET 1 OF 1

CUSTOMER P/N: