

SPECIFICATION FOR APPROVAL
PRODUCT APPROVAL SHEET

PRODUCT NAME : Tactile Switch

PART NO : 12x12mm Four-pin Surface-Mount Device

PART NO : _____

DESIGNED BY	CHECK BY	APPROVED BY	
WU Yongyu	WU Yongyou	ZHANG Peng	
DATE 20201117	DATE 20201117	DATE 20201117	

APPROVAL SIGNATURE

CUSTOMER NAME: _____

CUSTOMER TYPE: _____

CUSTOMER NO: _____

PLEASE ACKNOWLEDGE AND RETURN BY _____ DATE: _____

PLEASE RETURN TO US AFTER CONFIRMED! THANK YOU!



ISSUE	DATE	WRTN	CHKD	Page 1 of 7
001	2020. 11. 17	WU	ZHANG	

Shenzhen Kinghelm Electronics Co., Ltd.		Product Line	Tact Switch
TACT SWITCH SPECIFICATION			
<p>1、GENERAL</p> <p>1.1 Application</p> <p>This specification is applied to the requirements for TACTILE SWITCH (MECHANICAL CONTACT)</p> <p>1.2 Operating Temperature Range</p> <p>-20 ~ 70 (Normal humidity,normal air pressure)</p> <p>1.3 Storage Temperature Range</p> <p>-40 ~ 85 (Normal humidity,normal air pressure)</p> <p>1.4 Test Conditions</p> <p>Unless otherwise specified,tests and measurement shall be made in the following standard conditions:</p> <p>Normal temperature.....5 ~ 35</p> <p>Normal humidity.....relative humidity 45% ~ 85%</p> <p>Normal air pressure.....86KPa ~ 106KPa</p> <p>If any doubt arise from the judgment, tests shall be conducted at the following conditions :</p> <p>Temperature.....20 ±2</p> <p>Relative humidity.....65%±5%</p> <p>Air pressure.....86KPa ~ 106KPa</p> <p>2、DETAILED SPECIFICATION</p> <p>2.1 Appearance:There should be no defects that affect the serviceability of product.</p> <p>2.2 Style and dimension:shall conform to the assemble drawings.</p>			
ISSUE	DATE	WRTN	CHKD
001	2020. 11. 17	WU	ZHANG
Page 2 of 7			

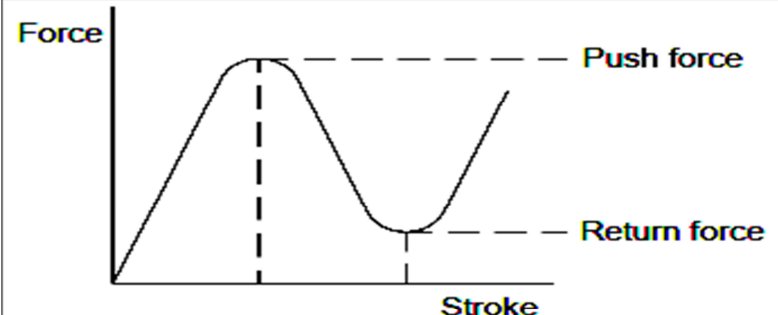
Shenzhen Kinghelm Electronics Co., Ltd.			Product Line	Tact Switch
TACT SWITCH SPECIFICATION				
2.3 Type of actuating:Tactile feedback. 2.4 Contact arrangement:1 pole,1 throw(Details of contact arrangement are given in the assembly drawings.) 2.5 Ratings:DC12V 50mA				
TEST ITEM				
3、 ELECTRINICAL PERORMANCE				
3-1 CONTACT RESISTANCE Being tested at 1kHz small current and voltage (50mA, 20mA) by contact resistance meter. 100M max.				
3-2 INSULATION RESISTANCE DC 250v shall be applied for test between terminals and between terminals and frame for one minutes. 100M min.				
3-3 WITHSTAND VOLTAGE AC 250v and induction current 1mA shall be applied for test between terminals and between terminals and frame for one minute. There shall be no breakdown.				
4、 MECHANICAL PERFORMANCE				
4-1 OPERATING FORCE 160±30gf 260±30gf		 <p>Force</p> <p>Stroke</p> <p>Push force</p> <p>Return force</p> <p>Push by recommended operating conditions</p>		
ISSUE	DATE	WRTN	CHKD	Page 3 of 7
001	2020. 11. 17	WU	ZHANG	

TACT SWITCH SPECIFICATION

5、DURABILITY

5-1 SOLDERING TEST

The tip of the terminal shall be dipped 0.5mm in the solder bath within temperature of 260 ± 5 for 3s.

Over 95% of the immersed surface was covered by tin.

5-2 SOLDERING RESISTANT TEST

Soldering temperature 260 ± 5 ,soldering time 3 ± 0.5 s,immersion depth up to the surface of the board,thickness of PCB 1.6mm.

Manual soldering temperature 350 ± 5 , soldering time 3 ± 0.5 s,however excessive pressure shall not be applied to the terminal.

Without deformation of case or excessive looseness of electrical properties.

5-3 REFLOW SOLDERING HEAR TEST

Without deformation of case or excessive looseness of electrical properties.

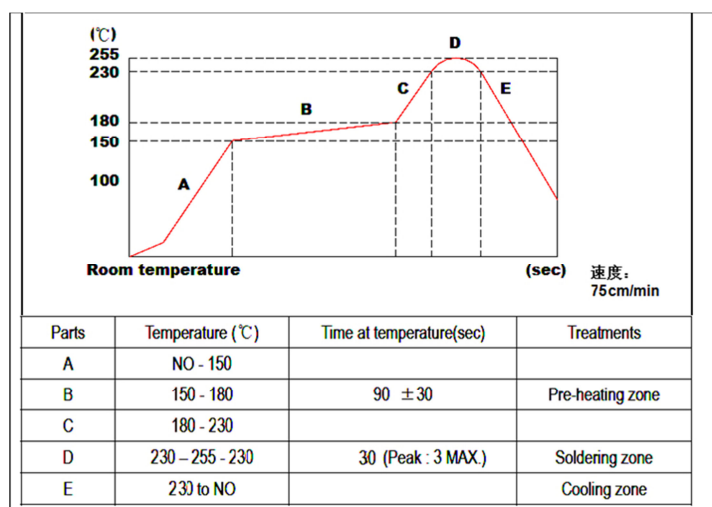

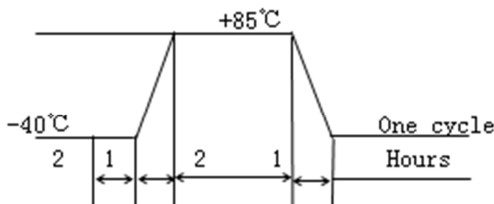
Shenzhen Kinghelm Electronics Co., Ltd.	Product Line	Tact Switch		
TACT SWITCH SPECIFICATION				
<div>5-4 LIFE TEST</div> <div>100,000 cycles of operation at a rate of 100-120 cycles per minute with unloading.</div> <div>(1)Contact resistance 200M .</div> <div>(2)Operating force 30%initial value.</div> <div>(3)ITEM---1.2</div> <div>(4)ITEM---1.3</div> <div>(5)ITEM---2.2</div>				
<div>5-5 SAIL SPRA</div> <div>1)Temperature: 35±2</div> <div>2)Cycle: 4 Hours testing(1Times) and 1 Hours stop. Based on total 4 hours.</div> <div>3)Salt solution concentration: 5±1% by weight.</div> <div>(1)Contact resistance 200M .</div> <div>(2)Insulation resistance 100M min.</div> <div>(3)There shall be no sign of mechanical and electrical damage.</div>				
<div>5-6 HEAT RESISTAN TEST</div> <div>80±2 for 96H,test after keeping in normal condition for 30 min.</div> <div>5-7 MOISTURE RESISTANT TEST</div> <div>At 60±2 90 ~ 95% RH for 96H,test after keeping in normal condition for 30 min.</div> <div>5-8 COLD RESISTANT TEST</div> <div>At -40±2 for 96H,test after keeping in normal condition for 30 min.</div> <div>5-9 TEMPERATURE CYCLIG TEST</div> <div>According to following figure,after 5 cycles,test after keeping in normal condition for 1H.</div>	<div></div> <div>(1)Contact resistance 200M .</div> <div>(2)Insulation resistance 100M min.</div> <div>(3)There shall be no sign of mechanical and electrical damage.</div>			
ISSUE	DATE	WRTN	CHKD	Page 6 of 7
001	2020. 11. 17	WU	ZHANG	

Kinghelm®

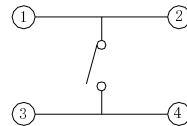
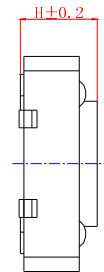
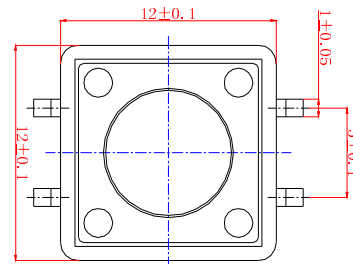
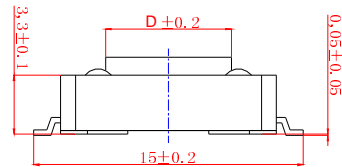

Circuit Diagram

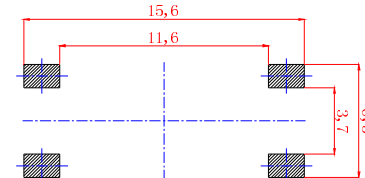

PCB Solder Diagram

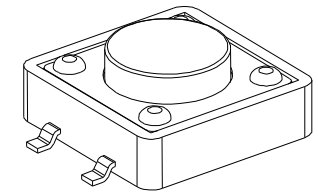
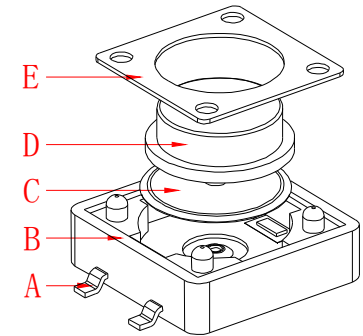

D	H
4.3	
5.0	
5.5	
6.0	
6.5	
7.0	
7.5	
8.0	
8.5	
9.0	
9.5	
10.0	
10.5	
11.0	
11.5	
12.0	
12.5	
13.0	
13.5	
14.0	
14.5	
15.0	
15.5	
16.0	
17.0	
18.0	
19.0	

Technical Specifications:
1. Rated Current: 50mA 12V DC
2. Contact Resistance: 100 milliohms
3. Stroke: 0.4 ± 0.1 mm
4. Resistance: 100 megohms
5. Withstand Voltage: 250V 50Hz 1Min

Press Force	160 ± 30gf	260 ± 50gf
Lifespan	100,000 cycles	100,000 cycles

E											First Angle Projection 	Scale	Specification /Part No	12*12 Four-pad Surface-mount Technology (SMT) Piece		E		
											General Tolerance							
	E	Cover	Iron	1	Tin-plated Copper						>0.5-2	±0.1	Unit	Material Number /Part No				
	D	Button	PPA Black	1	Cleaning						>2-5	±0.2						
	C	Spring	Stainless Steel	1		Label	Revision Number	Change Document Number	Signature	Date	Greater than 5	±0.3	mm					
										Angle	±1°							
F	B	Base	PPA Black	1	Cleaning	Designed			Checked		Approved		Shenzhen Kinghelm Electronics Co., Ltd.			www.kinghelm.net		F
	A	Contact	Brass	1	Sliver plating	WU Yongyu			ZHANG Peng		HE Chunlin		KH-12X12X7H-SMT-D					
	NO.	Name	Material	Quantity	Remarks													