

Flat Push Button (R)

Circuit Diagram

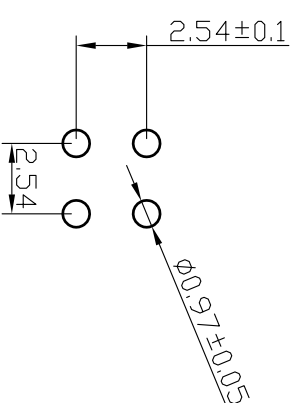
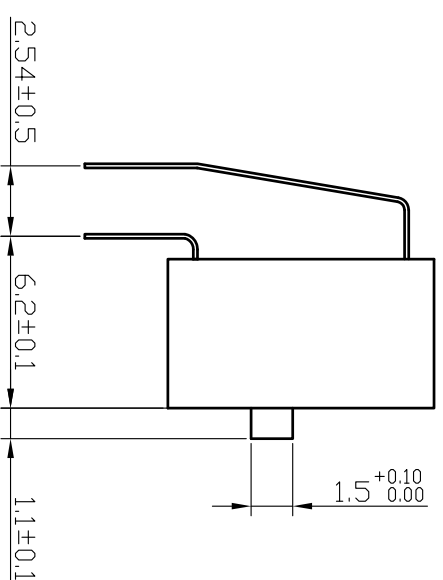
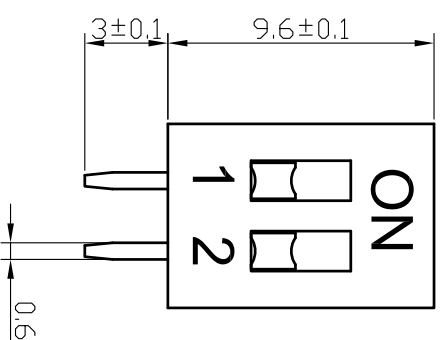

Uneven Push Button (E)

PCB Opening

- Switching Characteristics :**
1. Switching Capacity: 25mA at 24VDC
 2. Insulation Resistance: 100M at 250VDC
 3. Contact Resistance: 50 Ω Max
 4. Insulation Strength: 500VAC/1min
 5. Operating force: 1000gf Max
 6. Electrical Life: 2000 Times
 7. Applicable Temperature: -20°C to 70°C (Ice-free)
 8. Soldering Requirements:

- Material :**
- Cover: PBT Plastic (Red or Blue)
 - Base: PBT Plastic (Black)
 - Operating Joystick: POM plastic (White)
 - Potting: Epoxy Resin
 - Terminal: Tin-plated Phosphor Bronze, Contact-plated 3 μ "(or All-gold plating 1μ ")
 - Sealing Tape: Polyimide Kapton

- Manual welding: 320 for no more than 2 seconds. (Soldering Iron at 30 Watts Max.)
- Wave Soldering: 260 °C for no more than 5 seconds, and the switch is disconnected during soldering and cleaning.
- The switch is disconnected when leaving the factory.

Model Description:

DA	E	-02	R	-GA	T	/XXX
Code of Terminal Bending	E Uneven Pushing	2	R Red B Blue N Black	GA All-gold GT Tin-gold	Optional Film Sticking	Additional Information

SHENZHEN KINGHELM ELECTRONIC CO., LTD.

WWW.BDS666.COM

Model: KH-BM2.54-2P-W

0755-83044319

Mark	Number of Revised	Section	Revised Document Number	Signature	YY/MM/DD	Stage Mark	Weight	Scale	Dial Switch
Designed			Standardization						
Checked							1	4: 1	
Craft			Approval						DA□-02□