

SPECIFICATIONS

- 1、Current Rating: 3A AC, DC
- 2、Voltage Rating: 250V AC, DC
- 3、Temperatuer Range: $-25^{\circ}\text{C} \sim +85^{\circ}\text{C}$
- 4、Contact Resistance: $20\text{m}\Omega$ Max
- 5、Insulation Resistance: $1000\text{M}\Omega$ Min
- 6、Withstanding Voltang: 1000V AC/minute
- 7、Material: Wafer Nylon46, Beige UL94V-0
PIN Brass Tin-plated

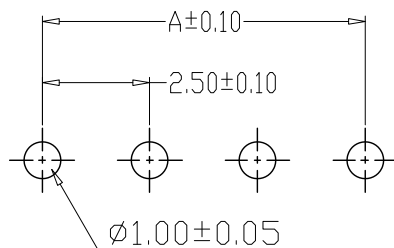
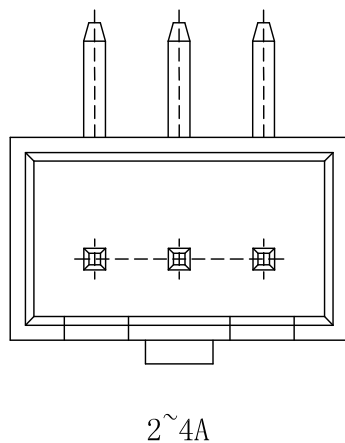
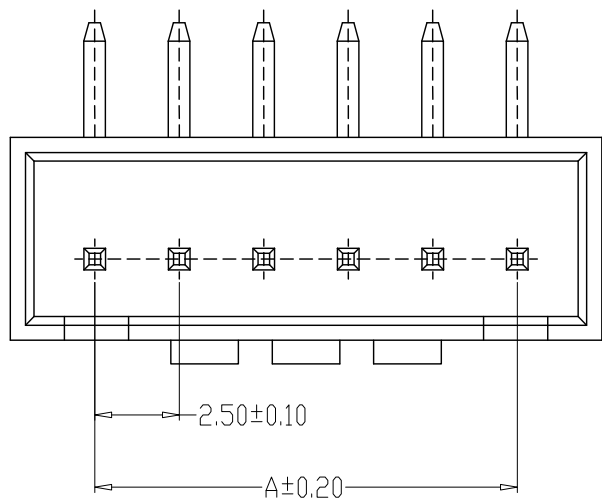

PCB LAYOUT

| 编 号 | 尺寸 (mm) | |
|------------|---------|-------|
| | A | B |
| A2504-02AW | 2.50 | 7.50 |
| A2504-03AW | 5.00 | 10.00 |
| A2504-04AW | 7.50 | 12.50 |
| A2504-05AW | 10.00 | 15.00 |
| A2504-06AW | 12.50 | 17.50 |
| A2504-07AW | 15.00 | 20.00 |
| A2504-08AW | 17.50 | 22.50 |
| A2504-09AW | 20.00 | 25.00 |
| A2504-10AW | 22.50 | 27.50 |
| A2504-11AW | 25.00 | 30.00 |
| A2504-12AW | 27.50 | 32.50 |
| A2504-20AW | 47.50 | 52.50 |

| 制图 DRAWN | 变更内容 DESCRIPTION | 日期 DATE | GENERAL TOLERANCE | | 制图 DRAWING | 钱岳生 | | 料号 PART NO. | A2504-NAW | | 版本 REV. | A |
|-------------|---------------------|------------|-------------------|------------|----------------|------------|-------------|-------------------|------------------------|---------------------|---------------|-----|
| | | | X.±0.25 | X.*±2' | | 2021、05、03 | 张名 | 品名 TITLE | HA弯针 WAFER DIP TYPE | | 页次 SHEET | 1/1 |
| | | | .X±0.20 | .X*±1' | 审核 CHECK | 2021、05、04 | 张名 | 客户料号 CUTM. NO. | | | | |
| | | | .XX±0.15 | .XX*±0.5' | 核准 APPROVAL | 2021、05、05 | 张名 | 深圳市金航标电子有限公司 | | www.kinghelm.com.cn | | |
| | | | .XXX±0.10 | .XXX*±0.5' | 单位 UNITS | MM | 比例 SCALE | 1:1 | KH-A2504-08AW | | 0755-28190160 | |