

Customer Drawing

Kinghelm®

REV	LTR	DESCRIPTION	DATE	APPROVED
A0		Issue Drawings According to New Part Numbering Principles	20181205	LTY
A1		Terminal Mold Modification	20190612	LDD

Remarks:

Materials:

- 1.1 Insulator Core: LCP + 30% G.F
- 1.2 Terminals: C1814, T = 0.12mm; Nickel base, Gold plating
- 1.3 Housing: Stainless steel, T = 0.30mm; Nickel-plated surface
- 1.4 Locking Hook: Stainless steel, T = 0.30mm

Main Characteristics:

- 2.1 Rated Current: 3.0A
- 2.2 Contact Resistance: 40m MAX
- 2.3 Insulation Resistance: 100M MIN @ 250V DC
- 2.4 Dielectric Strength Test: 100V AC
- 2.5 Solderability: Temperature 250 ± 5 , Time $5 \pm 0.5s$
- 2.6 Insertion Force: 2.0kgf MAX
Extraction Force: 0.6kgf MIN
- 2.7 Durability: 5000 cycles
- 2.8 Operating Temperature: -30 to +80

PIN ASSIGNMENT:

Pin No.	Signal Name	Pin No.	Signal Name
A1	CND	B12	CND
A2		B11	
A3		B10	
A4	VBUS	B9	VBUS
A5	CC1	B8	SBU2
A6	D+	B7	D-
A7	D-	B6	D+
A8	SBU1	B5	CC2
A9	VBUS	B4	VBUS
A10		B3	
A11		B2	
A12	CND	B1	CND

TOLERANCES

.X ± 0.30
.XX ± 0.20
.XXX ± 0.10
ANGLES $\pm 1.00^\circ$

Shenzhen Kinghelm Electronics Co., Ltd.

www.kinghelm.net

KH-TYPE-C-W-16P-T

0755-83044319

TITLE:0

USB Type C/F Onboard 16-Pin, Center Mount 1.78

DRAWING NO.:

812039-141



APPD.:

CHECK:

DRAWN:

REV.:

SIZE:

UNIT:

SCALE:

SHEET:

A/1

A4

MM

1:1

1/1

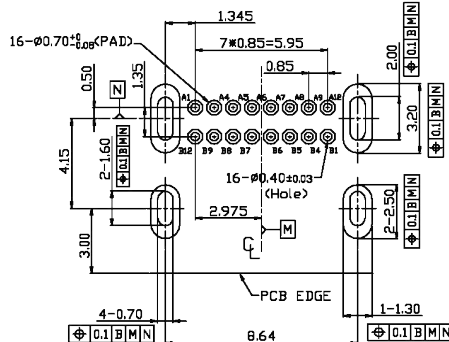
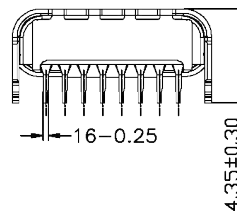
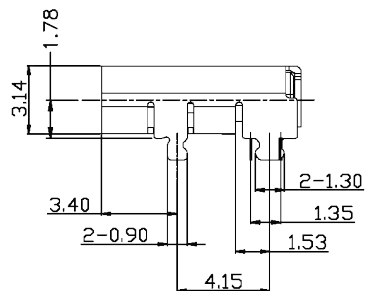
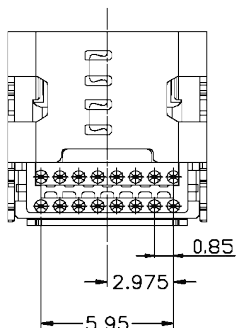
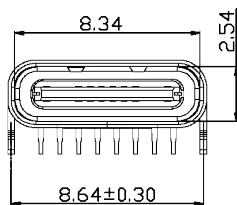
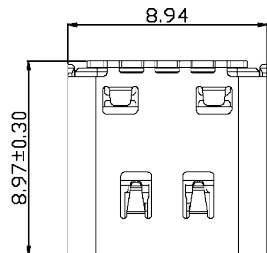

RECOMMENDED P.C.B LAYOUT

GENERAL TOLERANCE: ± 0.05
PCB TOP SURFACE