

Kinghelm®

REVISIONS					
REV	NUMBER	DESCRIPTION	DWN	CHK	DATE
A		DESIGN			

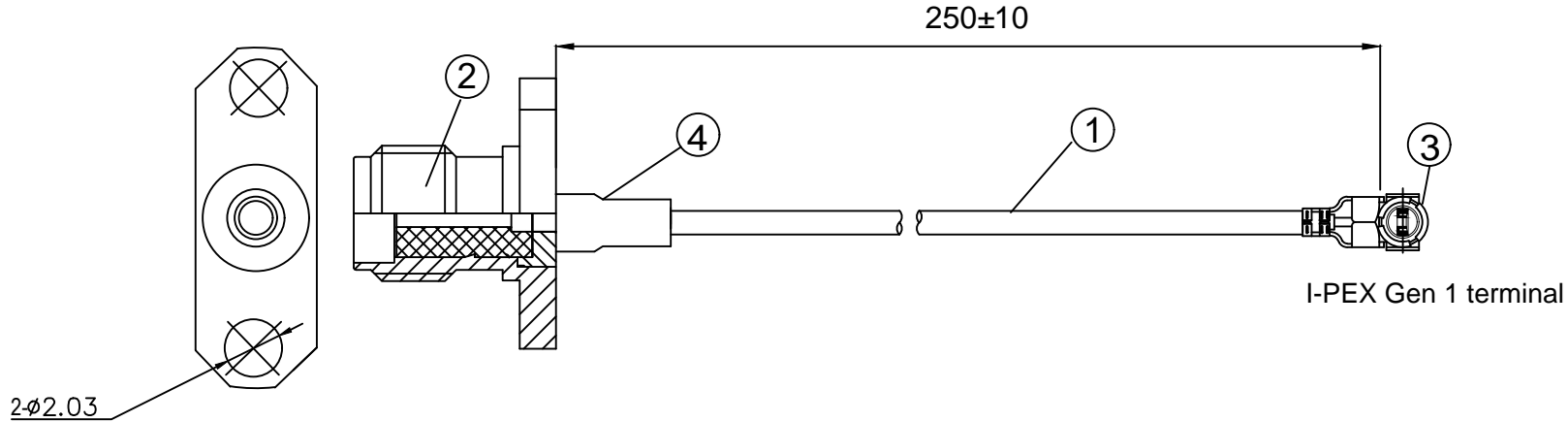

NOTES:

1. ELECTRICAL:
 - 1.1. VOLTAGE RATING:DCV 300V 10MS
 - 1.2. CONDUCTANCE RESISTANCE: 3.0 OHM/MAX.
 - 1.3. INSULATION RESISTANCE: 5.0M OHM/MIN.
 - 1.4. THE CABLE SHOULD BE 100% ELECTRICAL TEST
 - 1.5. IT SHOULD BE NO ANY OPEN/SHORT, MISWIRING AND INTERMITTENT FAILURES.
2. MATERIAL:
 - 2.1. SEE TABLE
3. ALL COMPONENTS ARE RoHS COMPLIANT.

ITEM NO.	PART NUMBER	DESCRIPTION	QTY.
④	Sleeve	Black heat shrink tubing, OD: 2.0mm	AS
③	Terminal	High-quality imitation I-PEX 1.37 first generation terminal, gold plated	1
②	Connector	SMA female connector with female pin, 2-hole flange, gold plated, external thread with internal hole	1
①	Coaxial cable	RF 1.37 cable, black coaxial cable, OD: 1.37mm	AS

Shenzhen Kinghelm Electronics Co., Ltd.

www.kinghelm.net

ALL DIMENSION ARE IN MM

DRAWN Jamy DATE 2023-08-18

ENG.

COMPUTER GENERATED IN SOLIDWORKS

MFG.

DO NOT SCALE THIS DRAWING

Q.A.

KH-FL2SMAK-IPEX-RG1.37-B250

PROJECTION

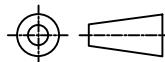

GENERAL TOLERANCE FOR ANGLES X.X X.XX X.XXX
± 1° ± 0.3 ± 0.25 ± 0.150

SIZE Number

B

REV

A

SCALE: Free

TYPE

SHEET 1 OF 1

CUSTOMER P/N: